

New SmallPumps™ SP200VOA Variable-Flow OEM

These low-cost peristaltic pumps provide variable flow and exception life performance. Flow rates are available from 0 to 320 ml/min. They adapt easily to almost any equipment application. Enjoy the benefits of peristaltic pumps in your fluid transfer application.

Select from 6 different Vdc motor speeds, four different tubing sizes and a variety of tubing materials. Tygon® A60G tubing offers the longest pump life, Silicone is the softest with higher flow rates. Viton provides excellent chemical resistance. New models available with optional ABS housing, power jack and on/off power switch.

These all-plastic pumps have SAN plastic housings, acetal rotor assembly with three nylon rollers. These brush Vdc motors are reversible. Silicone and Tygon A60G pump systems are supplied with polypropylene fittings. Viton systems are supplied with PVDF fittings. One year warranty.

Installation Note: These brush-type Vdc motors are rated for intermittent duty. Request information on our brushless dc motors for continuous-duty applications.

SPECIAL FEATURES

Fluid only contacts the tubing
Self-priming, run dry without damage
Variable-flow 12 & 24Vdc motors
Pump viscous fluids and slurries
Compact size

SPECIFICATIONS

	Tygon®, Viton®	Silicone
Max. Fluid Pressure:	30 psig (2 bar)	10 psig (0.7 bar)
Max. Suction Lift:		
0.8 and 1.6 mm ID	16-ft (4.8 m) H ₂ O	16-ft (4.8 m) H ₂ O
3.0 and 5.0 mm ID	25-ft (7.5 m) H ₂ O	25-ft (7.5 m) H ₂ O
Measurement Range:	See ordering table (page 2)	
Accuracy:	±10% full scale	
Repeatability:	±10% full scale	
Max. Fluid Temp.:	93°C (200°F)	
Duty Cycle:	Intermittent	
Operating Temp.:	0 to 50°C (32 to 122°F)	
Enclosure:	open motor systems; ABS optional	
Wetted parts:	Silicone, Tygon® A60G or Viton®	
Power:	12 or 24Vdc; up to 900 mA	
Dimensions (W x H x D):	60 x 74 x 90 mm (2.4 x 2.9 x 3.5 in.)	
(with housing)	84 x 140 x 97 mm (3.3 x 5.5 x 3.8 in.)	
Weight:	260 g (9.2 oz); 570 kg (20 oz)	
Shipping Wt:	0.45 kg (1 lb); 0.9 kg (2 lbs)	

All-plastic pump head
Variable-flow
Reversible

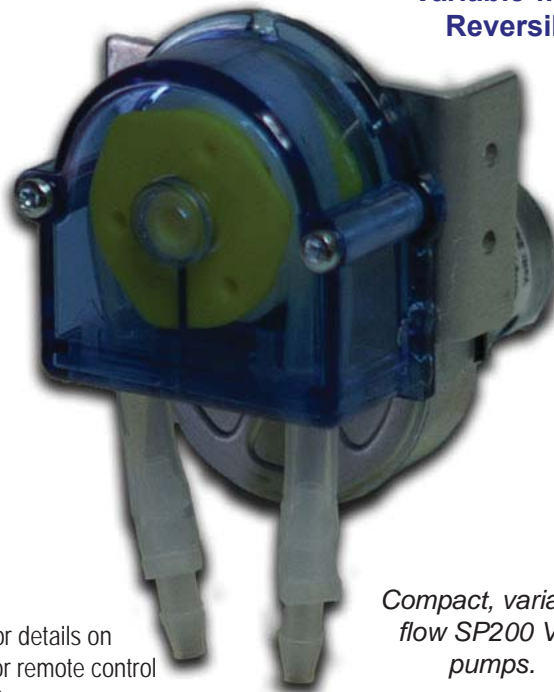

Inquire for details on manual or remote control PCB systems.

Compact, variable-flow SP200 Vdc pumps.

APPLICATIONS

Chemical metering
Reagent dispensing
Condensate removal
Analytical instruments
Research & Development

SP200VOA Max Flowrates (ml/min)

Motor RPM	Vdc	Amps	Tubing ID (mm)			
			5.0	3.0	1.6	0.8
320	12	900 mA	320	170	42	12
150	12	300 mA	145	78	19	5.5
70	12	200 mA	67	36	9	2.5
300	24	300 mA	290	156	39	11
220	24	150 mA	210	114	28	8
140	24	100 mA	135	72	18	5

Flow rate listed are nominal and will vary depending upon fluid viscosity and back pressure. Specifications listed are for Tygon A60G (formerly Norprene) tubing. Silicone flow rates are approx 10-20% higher. Viton flow rates slightly lower.

SP200VOA-Peri Pumps

SP200VOA Ordering Information – (Flow rates listed are for Tygon A60G tubing; Silicone is 10-20% higher).

Flow Rate ml/min	Tubing ID	RPM Range	Tygon® A60G	Pump Part No. Silicone	Viton®
12Vdc Pumps - Variable-flow; reversible; up to 900 mA current draw					
0 to 320	5.0 mm (3/16")	0 to 320	SP201-517	SP200-517	SP202-517
0 to 170	3.0 mm (1/8")	0 to 320	SP201-516	SP200-516	SP202-516
0 to 145	5.0 mm (3/16")	0 to 150	SP201-515	SP200-515	SP202-515
0 to 78	3.0 mm (1/8")	0 to 150	SP201-513	SP200-513	SP202-513
0 to 67	5.0 mm (3/16")	0 to 70	SP201-512	SP200-512	SP202-512
0 to 42	1.6 mm (1/16")	0 to 320	SP201-510	SP200-510	SP202-510
0 to 36	3.0 mm (1/8")	0 to 70	SP201-509	SP200-509	SP202-509
0 to 19	1.6 mm (1/16")	0 to 150	SP201-508	SP200-508	SP202-508
0 to 12	0.8 mm (1/32")	0 to 320	SP201-506	SP200-506	SP202-506
0 to 9	1.6 mm (1/16")	0 to 70	SP201-505	SP200-505	SP202-505
0 to 5.5	0.8 mm (1/32")	0 to 150	SP201-504	SP200-504	SP202-504
0 to 2.5	0.8 mm (1/32")	0 to 70	SP201-502	SP200-502	SP202-502
24Vdc Pumps - Variable-flow; reversible; up to 500 mA current draw					
0 to 290	5.0 mm (3/16")	0 to 300	SP201-561	SP200-561	SP202-561
0 to 210	5.0 mm (3/16")	0 to 220	SP201-560	SP200-560	SP202-560
0 to 156	3.0 mm (1/8")	0 to 300	SP201-559	SP200-559	SP202-559
0 to 135	5.0 mm (3/16")	0 to 140	SP201-558	SP200-558	SP202-558
0 to 114	3.0 mm (1/8")	0 to 220	SP201-557	SP200-557	SP202-557
0 to 72	3.0 mm (1/8")	0 to 140	SP201-556	SP200-556	SP202-556
0 to 39	1.6 mm (1/16")	0 to 300	SP201-555	SP200-555	SP202-555
0 to 28	1.6 mm (1/16")	0 to 220	SP201-554	SP200-554	SP202-554
0 to 18	1.6 mm (1/16")	0 to 140	SP201-553	SP200-553	SP202-553
0 to 11	0.8 mm (1/32")	0 to 300	SP201-552	SP200-552	SP202-552
0 to 8	0.8 mm (1/32")	0 to 220	SP201-551	SP200-551	SP202-551
0 to 5	0.8 mm (1/32")	0 to 140	SP201-550	SP200-550	SP202-550

Flow rates listed are nominal and will vary depending upon fluid viscosity and back pressure.

*Other special tubing options are available on special order. Call for details.

Customize your OEM pumps!

Order your OEM pump with an optional protective ABS plastic housing and power switch. All cased and switched models include a 5.5 x 2.5 mm jack for quick power connect. Add the following letter(s) to the p/n to include the options.

"C" ABS plastic housing (e.g. SP201C-551).

"CS" ABS plastic housing w/ on-off switch (e.g. SP201CS-551).



FRONT

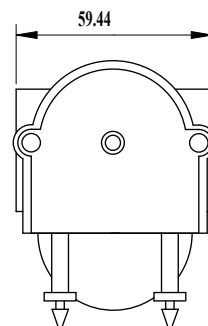

SIDE

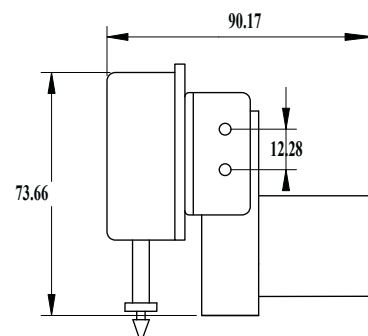

For more information contact:

APT Instruments

Omaha, NE 68144 USA

877.324.5444 Toll-free

217.498.0342 * 217.498.0352Fx

www.aptinstruments.com

sales@aptinstruments.com

Specifications subject to change.

APT Instruments provides no warranty on usage of pumps or life of tube.

Immersion and life tests are recommended prior to use.

APT logo—TM Advanced Product Technology, LLC Viton—Reg TM DuPont Dow Elastomers LLC

Tygon—Reg TM Saint Gobain Performance Plastics Corp.

©Copyright 2009-18Advanced Product Technology, LLC.